



**+ HEAVY LIFT  
CONSTRUCTION**



**+ URBAN  
MUNICIPAL**



**+ LOGISTIC  
TRANSPORTS**



**+ AGRICULTURE**

Thanks to the use of Hall Effect technology, **JX-5** offers a virtually infinite electrical life and a mechanical life over 5 million cycles. Thanks to its high mechanical strength and considerable resistance to vibrations, the **JX5** model is ideal for Off-Highway, Marine and Industrial applications.

The Joystick is available in **single**, **dual** and **tri-axis versions** with different handle types and with a high IP seal rating. single, dual and tri-axis versions with different handle types and with a high IP seal rating.

### PRODUCT CODE

JX-5

**A**

— —

**B**

— —

**C**

—

**D**

— —

**E**

—

**F**

— — —

**G**

— — —

**ORDER  
CODE**

A	AXIS
X	= Axis x
Y	= Axis y
XY	= Axis xy

C	GATE
R	= Circular
C	= Cross

E	DIRECTIONAL SIGNAL
Y	= Yes
N	= No

G	CUSTOMIZED VERSION
XXX	= Yes

B	OUTPUT
H	= 0,5 - 4,5 V dual cross
HI	= 4,5 - 0,5 V dual cross
HP	= 0,5 - 4,5 V dual parallel
HC	= 4 ÷ 20 mA
CB	= CANbus

D	MECHANICAL FEATURES
NL	= Return spring

F	HANDLE
AF	= AF STYLE (NO SWITCH)*
AF1R	= AF STYLE (1 TOP SWITCH)*

\* See datasheet AF handle.

### ELECTRICAL CHARACTERISTICS

OPERATIONAL VOLTAGE	5 V $\pm$ 0,5 V
OUTPUT SIGNAL	0,5 ... 4,5 V; 4:20 mA; CAN-Bus
LINEARITY	$\pm$ 3%
DEFLECTION ANGLE, EL.	$\pm$ 19°
POWER CONSUMPTION	< 20 mA
MAX. OUTPUT CURRENT	$\pm$ 8 mA
RESOLUTION	16 bit
OPTION	Redundant output signal
ELECTROSTATIC DISCHARGE	BS EN 61000-4-2
RADIO INTERFERENCE	BS EN 61000-4-3
HIGH-FREQUENCY INTERFERING SIGNALS	BS EN 61000-4-4
CONDUCTED INTERFERING SIGNALS	BS EN 61000-4-6
RADIATED EMISSION	EN 55016-2-3:2010+A1:2010

Specifications are subject to change without notice. \* Other values on request.

### MECHANICAL CHARACTERISTICS

SERVICE LIFE	5 million cycles
DEFLECTION ANGLE, MECH.	$\pm$ 19°
OPERATING FORCE	3,5 N typically *
CENTRE POSITION TOLERANCE	$\pm$ 1°
IMPACT STRENGTH	500 N

### ENVIRONMENTAL CHARACTERISITICS

STORAGE TEMPERATURE	-40°C ... +85°C
OPERATING TEMPERATURE	-25°C ... +70°C
PROTECTION CLASS (ABOVE MOUNTING FLANGE)	IP65

### + MATERIALS

Base: Aluminium

Bearing: Stainless steel/plastic

### INSTALLATION DIAGRAM

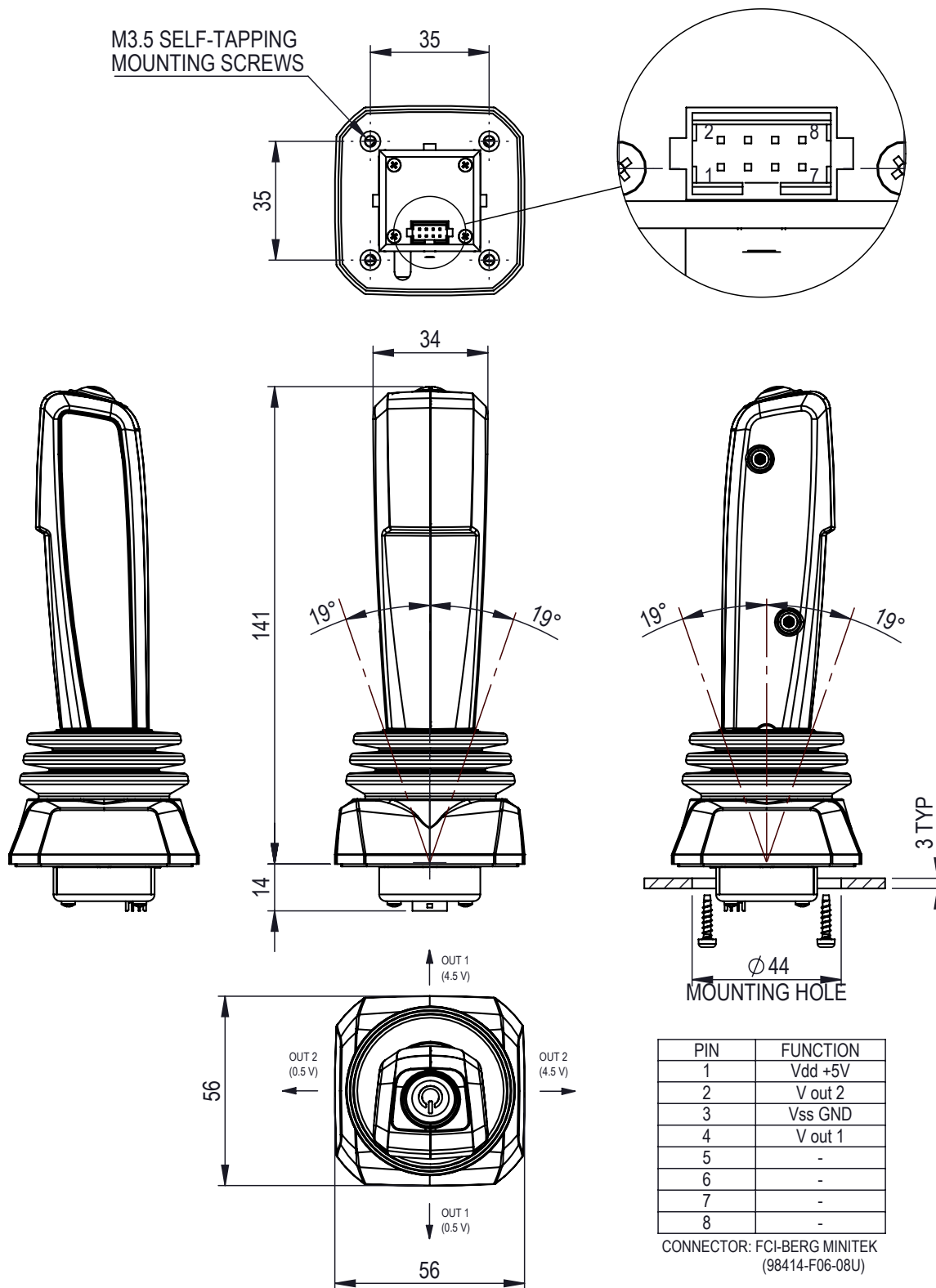

U-CONTROL Srl. - Via Micheli 9, 43056 San Polo di Torrile (PR)

Tel. +39 0521 273823 | Mail: info@u-control.eu | www.u-control.eu | P.IVA 02722200348

\* The company reserves the right to make any kind of design or functional modification at any moment without prior notice